

Kingtronics®

RKT-WF

Wirewound Potentiometer

Electrical Characteristics

Standard Resistance Range	100Ω~47KΩ
Resistance Tolerance	±5%
Independent Linearity	±0.3%
Rated Power	2W (85°C)
Voltage Rating	160V

Mechanical Characteristics

Total Mechanical Travel	3600°±10°
Starting Torque	3.5-100mN.m

Common Dimensions

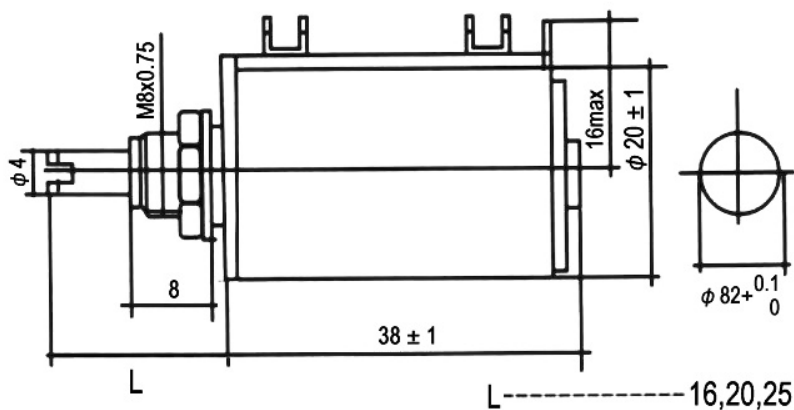

Note: Specifications are subject to change without notice.

Kingtronics® International Company

Website: www.kingtronics.com Email: info@kingtronics.com Tel: (852) 8106 7033 Fax: (852) 8106 7099