

Kingtronics®

FKT-CBB61

Motor Capacitor CBB61

FEATURES

- ◆ Electrical apparatus use metalized film with precisely quality control
- ◆ Low D.F. (dissipation factor), lower temperature rise.
- ◆ High I.R. (insulation resistance) small size
- ◆ High safety & high reliability
- ◆ Durability and characteristics of frequency, etc



SPECIFICATIONS

Operating Condition	-40°C ~ +85°C
Capacitance Range	1µF ~ 20µF(FKT-B~D、FKT-5~7、FKT-9)
Capacitance Tolerance	J(±5%) · K(±10%)
Rated Voltage	250V 450V (AC)
Withstand Voltage	AC≥2U _R 2S(I _{max} ≤1.3 InA)
Dissipation Factor	≤0.003 1KHz(FKT-B~D、FKT-5~7、FKT-9)
Insulation Resistance	≥3000S

DRAWING:

FKT-B

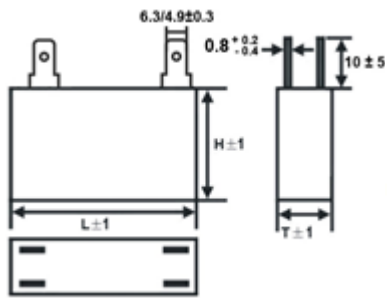

FKT-C

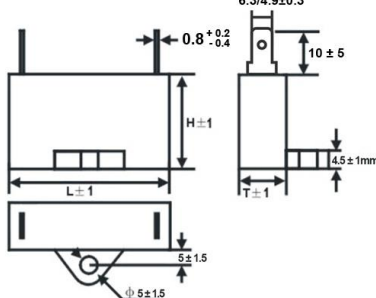

FKT-D

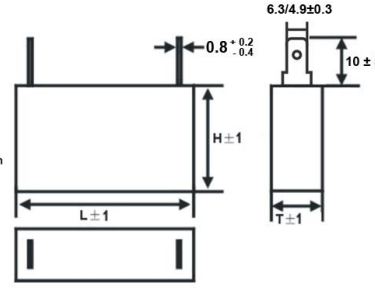

FKT-5

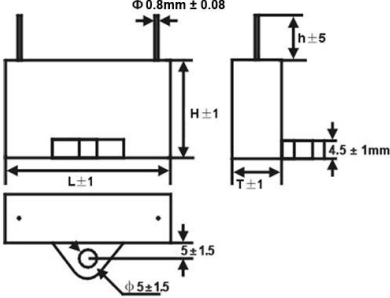

FKT-6

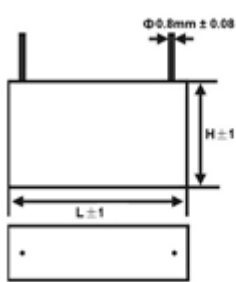

FKT-7

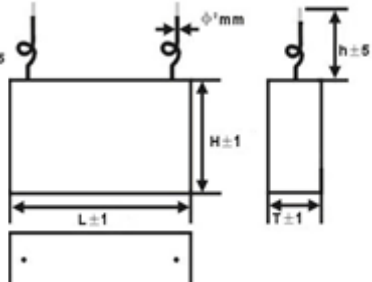

FKT-8

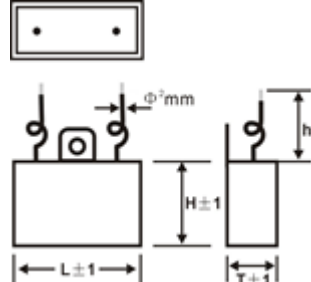

FKT-9

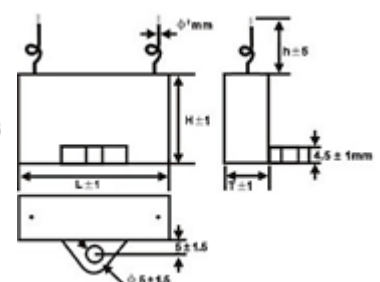

Remark:

For FKT-7, FKT-8, FKT-9 Two wires leads maybe will not in center position, different wire position does not make any change in capacitors installation and electrical performance.

Note: Specifications are subject to change without notice. For more detail and update, please visit our website

Kingtronics® International Company

Website: www.kingtronics.com

Email: info@kingtronics.com

Tel: (852) 8106 7033

Fax: (852) 8106 7099

Kingtronics® FKT-CBB61

Motor Capacitor CBB61

Dimensions For Motor Running Capacitors CBB61

(mm)

CAP	FKT-C, FKT-5						FKT-B, FKT-D					
	250VAC			450VAC			250VAC			450VAC		
μF	L	T	H	L	T	H	L	T	H	L	T	H
0.5	26.5	12.5	21	26.5	12.5	21	26.5	12	20	25.5	12	20
1	26.5	12.5	21	32	14	24	26.5	12	20	32	14	25
2	32	14	24	37	17	28	32	14	25	37	17	28
2.5	32	14	24	37	17	28	32	14	25	37	17	28
3	32	14	24	38	20	30	32	14	25	38	20	30
5	37	17	28	47	20	34	37	17	28	47	20	34
6	37	17	28	47	23	34	37	17	28	47	23	34
8	47	17.5	33	47	28	34	47	18	32	47	28	34
10	47	17.5	33	47	32	40	47	18	32	47	30	40
12	47	23	34	47	32	43	47	23	34	--	--	--
15	47	25	34	--	--	--	47	25	34	--	--	--
20	47	28	37	--	--	--	47	28	37	--	--	--

CAP	FKT-6								FKT-7					
	250VAC				450VAC				250VAC			450VAC		
μF	L	T	H	P	L	T	H	P	L	T	H	L	T	H
0.5	32	10	20	27.5	32	10	20	27.5	32	10	20	32	10	20
1.0	32	10	20	27.5	36	10	20	31.5	32	10	20	36	10	20
1.2	36	10	20	31.5	36	11	22	31.5	36	10	20	36	11	22
1.5	36	10	20	31.5	36	12	22	31.5	36	10	20	36	12	22
1.8	36	11	22	31.5	36	12	22	31.5	36	11	22	36	12	22
2.0	36	11	22	31.5	37	13	23	31.5	36	11	22	37	13	23
2.5	37	12	21	31.5	38	15	25	31.5	37	12	21	38	15	25
3.0	37	13	23	31.5	38	17	28	31.5	37	13	23	38	17	28
3.5	38	15	25	31.5	38	18.5	29	31.5	38	15	25	38	18.5	29
4.0	38	17	28	31.5	38	18.5	29	31.5	38	17	28	38	18.5	29
4.5	38	17	28	31.5	38	21	32	31.5	38	17	28	38	21	32
5.0	38	18.5	29	31.5	38	21	32	31.5	38	18.5	29	38	21	32
6.0	38	19.5	31	31.5	38	21	32	31.5	38	19.5	31	38	21	32
7.0	38	21	32	31.5	47	23	35	41.5	38	21	32	47	23	35
8.0	38	21	32	31.5	47	23	35	41.5	38	21	32	47	23	35
10.0	47	23	35	41.5	47	23	35	41.5	47	23	35	47	23	35
12.0	47	23	35	41.5	48	33	45	41.5	47	23	35	48	33	45
15.0	47	23	35	41.5	48	33	45	41.5	47	23	35	48	33	45
16.0	47	23	35	41.5	57	32	44	51.5	47	23	35	57	32	44
18.0	47	23	35	41.5	57	32	44	51.5	47	23	35	57	32	44
20.0	48	33	45	41.5	57	32	44	51.5	48	33	45	57	32	44

CAP	FKT-9												
	250VAC			450VAC			(μF)	250VAC			450VAC		
(μF)	L	T	H	L	T	H	(μF)	L	T	H	L	T	H
0.5	32	10	20	32	10	20	5.0	38	18.5	29	38	24	33
1.0	32	10	20	36	10	20	6.0	38	19.5	31	38	24	33
1.2	36	10	20	36	11	22	7.0	38	21	32	47	23	35
1.5	36	10	20	36	12	22	8.0	38	24	33	47	26	38
1.8	36	11	22	36	12	22	10.0	47	23	35	47	26	38
2.0	36	11	22	37	13	23	12.0	47	23	35	48	33	45
2.5	37	12	21	38	15	25	15.0	47	26	38	48	33	45
3.0	37	13	23	38	17	28	16.0	47	26	38	57	32	44
3.5	38	15	25	38	18.5	29	18.0	47	26	38	57	32	44
4.0	38	17	28	38	18.5	29	20.0	48	33	45	57	32	44
4.5	38	17	28	38	21	32							

Note: Specifications are subject to change without notice. For more detail and update, please visit our website

Kingtronics® International Company

Kingtronics®

FKT-CBB61

Motor Capacitor CBB61

HOW TO ORDER

FKT	6	E2	105	K	000	000	B	R
Series	Sub Series	Voltage	Capacitance	Capacitance Tolerance	Pitch	Lead Length	Packing	Pb
		1.	2.	3.	4.	5.	6.	7.

NOTE:

1. Voltage

Code	E2	S2
Voltage	250 VAC	450 VAC

2. Capacitance

Code	105	125	205	305	505	605	805
Capacitance	1 μ F	1.2 μ F	2 μ F	3 μ F	5 μ F	6 μ F	8 μ F
Code	106	126	156	166	186	206	
Capacitance	10 μ F	12 μ F	15 μ F	16 μ F	18 μ F	20 μ F	

3. Capacitance Tolerance

Code	J	K
Tolerance	\pm 5%	\pm 10%

4. Pitch

Code	000
Pitch (mm)	Standard

5. Lead Length

Code	000
Lead Length	Standard

6. Packing

Code	B
Packing	Bulk

7. Pb

Code	R
Pb	RoHS

Note: Specifications are subject to change without notice.

Kingtronics® International Company

Website: www.kingtronics.com

Email: info@kingtronics.com

Tel: (852) 8106 7033

Fax: (852) 8106 7099