

# Kingtronics®

## DKT-DY

### Combined Type Super Capacitor

## FEATURES

- ◆ Low leakage current
- ◆ Standard energy type
- ◆ Pb-free and RoHS compliant



## SPECIFICATIONS

Series name	DKT-DY Series Combined Type	
Type name	DKT-DY 5R0	DKT-DY 7R5
Rated voltage $V_R$	5.0V	7.5V
Surge voltage	5.4V	7.9V
Capacity range	0.1F~5F	0.1F~3.3F
Operating temperature range	-25~ +70°C	
Product life	Normal temperature cycle life : 25°C, 1 million cycles between $V_R$ and $1/2V_R$ , Capacity attenuation $\leq 30\%$ , ESR change $\leq 4$ times. High temperature endurance life : Maximum temperature retention $V_R$ · 1000 hours. Capacity attenuation $\leq 30\%$ , ESR change $\leq 4$ times.	

## DIMENSIONS (mm)

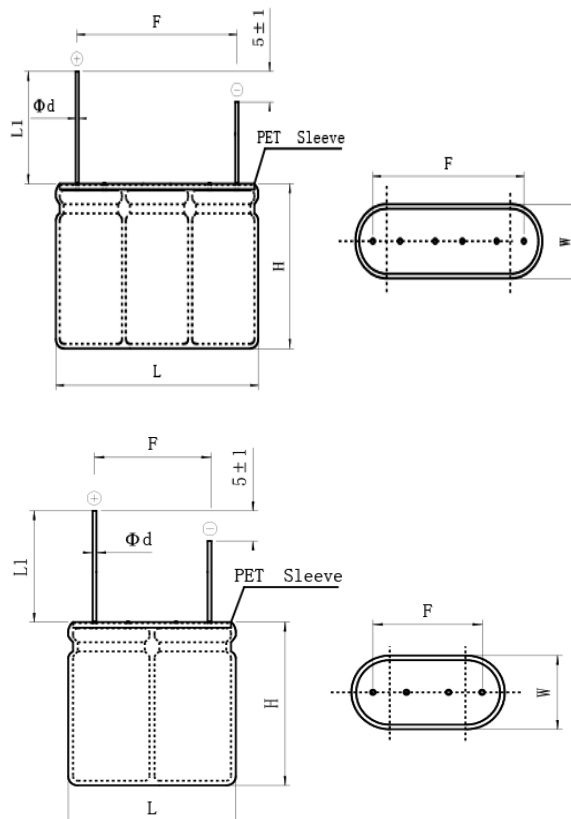

**Kingtronics® International Company**

**Kingtronics**®**DKT-DY**

Combined Type Super Capacitor

**STANDARD RATINGS**

Nominal Voltage (V)	Capacity (F)	ESR mΩ		Product size (mm)			
		DC	AC 1kHz	L	W	H	F
5.0	0.1	3600	2400	11	6	13	7
5.0	0.1	3600	2400	13	7	14	9
5.0	0.22	3000	2000	11	6	13	7
5.0	0.22	3000	2000	13	7	14	9
5.0	0.33	2700	1800	17	9	15	12
5.0	0.47	2100	1400	13	7	14	9
5.0	0.47	2100	1400	17	9	15	12
5.0	1	900	600	17	9	15	12
5.0	1	900	600	17	9	21	12
5.0	1	900	600	21	10	21	15
5.0	1.5	750	500	21	10	21	15
5.0	1.5	900	600	17	9	21	12
5.0	2	420	280	26	13	22	18
5.0	2	480	320	21	10	21	15
5.0	2.5	390	260	21	10	21	15
5.0	2.5	390	260	26	13	22	18
5.0	3	390	260	21	10	21	15
5.0	3	390	260	26	13	22	18
5.0	4	360	240	26	13	22	18
5.0	5	300	200	26	13	27	18
7.5	0.1	4500	3000	19.5	7	14	10
7.5	0.33	2700	1800	25	9	15	13.5
7.5	0.7	1350	900	25	9	21	13.5
7.5	1	1350	900	25	9	21	13.5
7.5	1.5	585	390	31	10	21	16
7.5	1.5	630	420	39	13	22	21
7.5	2	585	390	31	10	21	16
7.5	3.3	450	300	39	13	27	21

**Kingtronics**® International CompanyWebsite: [www.kingtronics.com](http://www.kingtronics.com) Email: [info@kingtronics.com](mailto:info@kingtronics.com) Tel: (852) 8106 7033 Fax: (852) 8106 7099

**Kingtronics**®**DKT-DY**

Combined Type Super Capacitor

**HOW TO ORDER**

<b>DKT</b>	<b>DY</b>	<b>2R7</b>	<b>104</b>	<b>M</b>	<b>00500120</b>	<b>020</b>	<b>000</b>	<b>R</b>	<b>B</b>	<b>R</b>
Series	Sub Series	Voltage	Capacity	Capacity Tolerance	Dimension	Pitch/Pins	Lead Length	Terminal Options	Packing	Pb
		1.	2.	3.	4.	5.	6.	7.	8.	9.

**NOTE:****1. Voltage**

Code	2R7	3R0
Voltage	2.7	3.0

**2. Capacity**

Code	104	105	106	107	108
Capacitance (F)	0.1	1.0	10	100	1000

**3. Capacity Tolerance**

Code	M	V	F
Tolerance	±20%	-10%~+20%	0%~+30%

**4. Dimension**

Code	00500120	00630125	01000200	01250210	01600260	05101080
Dimension (mm)	5x12	6.3x12.5	10x20	12.5x21	16x26	51x108

**5. Pitch/Pins/Screw**

Code	016	020	025	035	050	075	100	127	218	282	4PS
Pitch (mm)/Pins	1.6	2.0	2.5	3.5	5.0	7.5	10.0	12.7	21.8	28.2	4pins

Code	000
Pitch (mm)	Screw

**6. Lead Length**

Code	000	040	045	050
Lead Length	Standard	4.0	4.5	5.0

**7. Terminal Options**

Code	R	S	W
Terminal Options	Radial	Snap-in	Screw

**8. Packing**

Code	A	B
Packing	Ammo	Bulk

**9. Pb**

Code	L	R
Pb	Leaded	RoHS

Note: Specifications are subject to change without notice.

**Kingtronics**® International CompanyWebsite: [www.kingtronics.com](http://www.kingtronics.com)Email: [info@kingtronics.com](mailto:info@kingtronics.com)

Tel: (852) 8106 7033

Fax: (852) 8106 7099