

# Kingtronics®

# SKT - Surge Arresters

## 3-Electrode Ceramic Surge Arrester

### COMMON DIMENSIONS

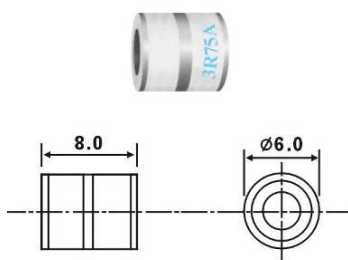

SKT-3R-A Type (  $\phi$  6x8)

### PICTURE



### Electrical Characteristics

Type	DC spark-over voltage (100V/s) V	Impulse spark-over voltage (1KV/us) V	Impulse discharge current (10/1000us 300times) A	Impulse discharge current (8/20us 10times) KA	AC discharge current (50Hz 1s 5 times) A	Holdover Voltage V	Insulation resistance $\Omega$	Capacitance pF	Transverse voltage durations
SKT-3R-75A	75 $\pm$ 25%	$\leq$ 600	50	5	5	/	$\geq 10^{10}$	<1.5	$\leq 200$
SKT-3R-90A	90 $\pm$ 25%	$\leq$ 600	50	5	5	/	$\geq 10^{10}$	<1.5	$\leq 200$
SKT-3R-105A	150 $\pm$ 20%	$\leq$ 700	100	5	5	80	$\geq 10^{10}$	<1	$\leq 200$
SKT-3R-230A	230	+30 I $\leq$ 800	100	5	5	80	$\geq 10^{10}$	<1	$\leq 200$
		-40 II $\leq$ 500	/						
SKT-3R-350A	350 $\pm$ 20%	I $\leq$ 800	100	5	5	80	$\geq 10^{10}$	<1	$\leq 200$
		II $\leq$ 600	/						
SKT-3R-470A	470 $\pm$ 20%	I $\leq$ 900	100	5	5	80	$\geq 10^{10}$	<1	$\leq 200$
		II $\leq$ 700	/						
SKT-3R-600A	600 $\pm$ 20%	$\leq$ 1200	100	5	5	80	$\geq 10^{10}$	<1	$\leq 200$

Note: Specification are subject to change without notice.

**Kingtronics® International Company**

Website: [www.kingtronics.com](http://www.kingtronics.com) Email: [info@kingtronics.com](mailto:info@kingtronics.com) Tel: (852) 8106 7033 Fax: (852) 8106 7099

# Kingtronics®

# SKT - Surge Arresters

## COMMON DIMENSIONS

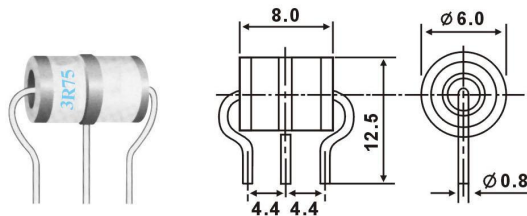

SKT-3R-AL<sub>1</sub> Type (Φ 6x8)

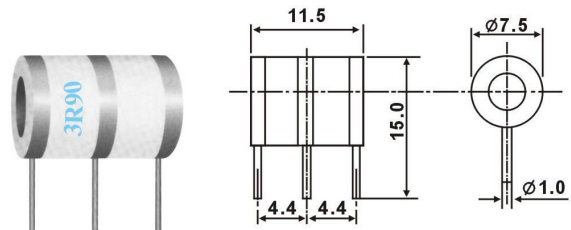

SKT-3R-AL<sub>2</sub> Type (Φ 7.5x11.5)

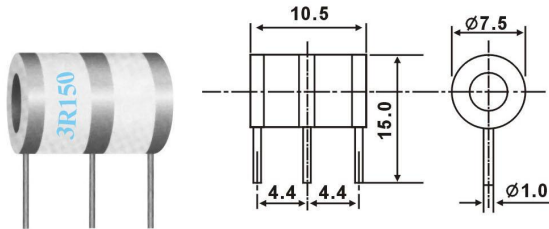

SKT-3R-AL<sub>3</sub> Type (Φ 7.5x10.5)

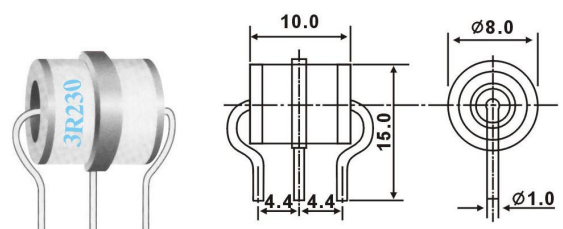

SKT-3R-AL<sub>4</sub> Type (Φ 8x10)

## Electrical Characteristics

Type	DC spark over voltage (100V/s) V	Impulse spark over voltage (1KV/us) V	Impulse discharge current (10/1000us 300times) A	Impulse discharge current (8/20us 10times) KA	AC discharge current (50Hz 1s 5 times) A	Holdover Voltage V	Insulation resistance Ω	Capacitance pF	Transverse voltage duration s
SKT-3R-75AL <sub>1</sub> SKT-3R-75AL <sub>2</sub> SKT-3R-75AL <sub>3</sub> SKT-3R-75AL <sub>4</sub>	75±25%	≤600	50	10	10	/	≥10 <sup>10</sup>	<1.5	≤200
SKT-3R-90AL <sub>1</sub> SKT-3R-90AL <sub>2</sub> SKT-3R-90AL <sub>3</sub> SKT-3R-90AL <sub>4</sub>	90±25%	≤600	50	10	10	/	≥10 <sup>10</sup>	<1.5	≤200
SKT-3R-150AL <sub>1</sub> SKT-3R-150AL <sub>2</sub> SKT-3R-150AL <sub>3</sub> SKT-3R-150AL <sub>4</sub>	150±20%	≤700	100	10	10	80	≥10 <sup>10</sup>	<1	≤200
SKT-3R-230AL <sub>1</sub> SKT-3R-230AL <sub>2</sub> SKT-3R-230AL <sub>3</sub> SKT-3R-230AL <sub>4</sub>	230	+30 I ≤800 -40 II ≤500	100 /	10	10	135	≥10 <sup>10</sup>	<1	≤200
SKT-3R-350AL <sub>1</sub> SKT-3R-350AL <sub>2</sub> SKT-3R-350AL <sub>3</sub> SKT-3R-350AL <sub>4</sub>	350±20%	I ≤800 II ≤600	100 /	10	10	135	≥10 <sup>10</sup>	<1	≤200
SKT-3R-470AL <sub>1</sub> SKT-3R-470AL <sub>2</sub> SKT-3R-470AL <sub>3</sub> SKT-3R-470AL <sub>4</sub>	470±20%	I ≤900 II ≤700	100 /	10	10	135	≥10 <sup>10</sup>	<1	≤200
SKT-3R-600AL <sub>1</sub> SKT-3R-600AL <sub>2</sub> SKT-3R-600AL <sub>3</sub> SKT-3R-600AL <sub>4</sub>	600±20%	≤1200	100	10	10	135	≥10 <sup>10</sup>	<1	≤200

Note: Specification are subject to change without notice.

**Kingtronics® International Company**

# Kingtronics®

# SKT - Surge Arresters

## COMMON DIMENSIONS

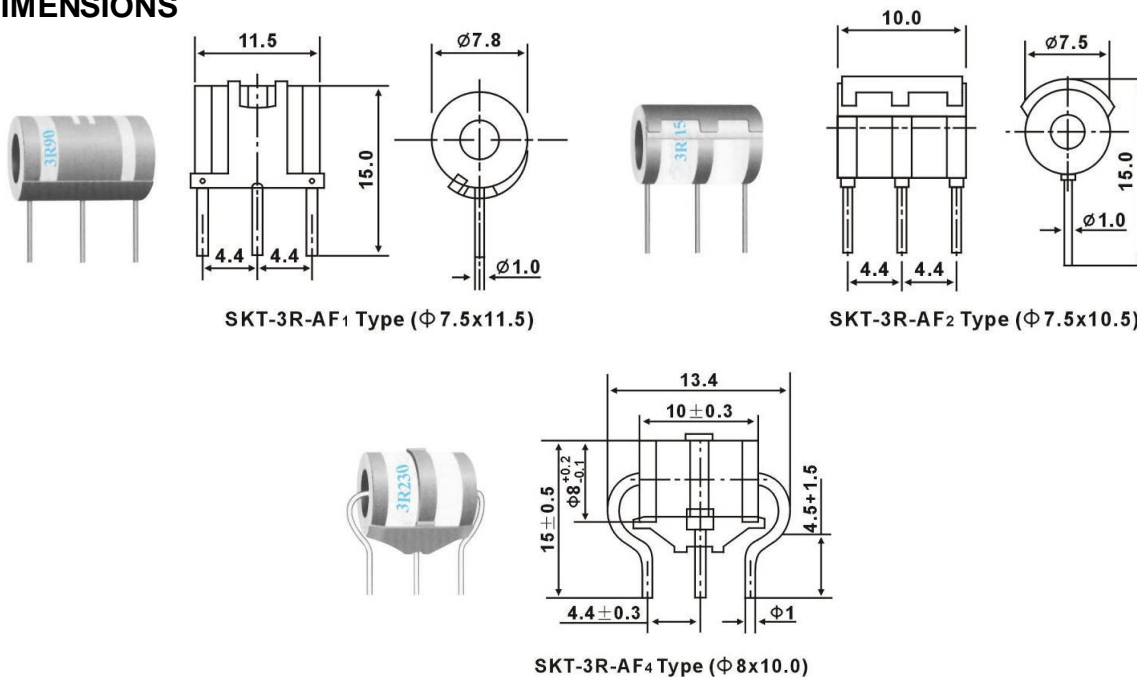

## Electrical Characteristics

Type	DC spark over voltage (100V/s) V	Impulse spark over voltage (1KV/us) V	Impulse discharge current (10/1000us 300times) A	Impulse discharge current (8/20us 10times) KA	AC discharge current (50Hz 1s 5 times) A	Holdover Voltage V	Insulation resistance Ω	Capacitance pF	Transverse voltage durations
SKT-3R-75AF <sub>1</sub> SKT-3R-75AF <sub>2</sub> SKT-3R-75AF <sub>4</sub>	75±25%	≤600	50	10	10	/	≥10	<1.5	≤200
SKT-3R-90AF <sub>1</sub> SKT-3R-90AF <sub>2</sub> SKT-3R-90AF <sub>4</sub>	90±25%	≤600	50	10	10	/	≥10	<1.5	≤200
SKT-3R-150AF <sub>1</sub> SKT-3R-150AF <sub>2</sub> SKT-3R-150AF <sub>4</sub>	150±20%	≤700	100	10	10	80	≥10	<1	≤200
SKT-3R-230AF <sub>1</sub> SKT-3R-230AF <sub>2</sub> SKT-3R-230AF <sub>4</sub>	+30 230 -40	I ≤800 II ≤500	100 /	10	10	135	≥10	<1	≤200
SKT-3R-350AF <sub>1</sub> SKT-3R-350AF <sub>2</sub> SKT-3R-350AF <sub>4</sub>	350±20%	I ≤800 II ≤600	100 /	10	10	135	≥10	<1	≤200
SKT-3R-470AF <sub>1</sub> SKT-3R-470AF <sub>2</sub> SKT-3R-470AF <sub>4</sub>	470±20%	I ≤900 II ≤700	100 /	10	10	135	≥10	<1	≤200
SKT-3R-600AF <sub>1</sub> SKT-3R-600AF <sub>2</sub> SKT-3R-600AF <sub>4</sub>	600±20%	≤1200	100	10	10	135	≥10	<1	≤200

Note: Specification are subject to change without notice.

**Kingtronics® International Company**

Website: [www.kingtronics.com](http://www.kingtronics.com) Email: [info@kingtronics.com](mailto:info@kingtronics.com) Tel: (852) 8106 7033 Fax: (852) 8106 7099

# Kingtronics®

# SKT - Surge Arresters

## COMMON DIMENSIONS

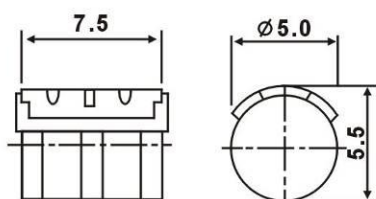

SKT-3R-PF<sub>5</sub> Type (Φ 5.0x7.5)

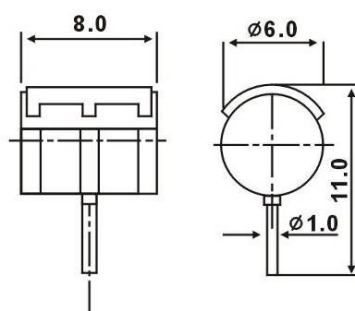

SKT-3R-PF<sub>7</sub> Type (Φ 6.0x8.0)

## Electrical Characteristics

Type	DC spark-over voltage (100V/s) V	Impulse spark-over voltage (1KV/us) V	Impulse discharge current (10/1000us 300times) A	Impulse discharge current (8/20us 10times) KA	AC discharge current (50Hz 1s 5 times) A	Holdover Voltage V	Insulation resistance Ω	Capacitance pF	Transverse voltage durations
SKT 3R-75PF <sub>5</sub> SKT 3R-75PF <sub>7</sub>	75±25%	≤600	50	10	10	/	≥10 <sup>10</sup>	<1.5	≤200
SKT 3R-90PF <sub>5</sub> SKT 3R-90PF <sub>7</sub>	90±25%	≤600	50	10	10	/	≥10 <sup>10</sup>	<1.5	≤200
SKT 3R-150PF <sub>5</sub>	150±20%	≤700	100	10	10	80	≥10 <sup>10</sup>	<1	≤200
SKT 3R-230PF <sub>5</sub>	230	I	≤800	100	10	135	≥10 <sup>10</sup>	<1	≤200
SKT 3R-230PF <sub>7</sub>			≤500	/					
SKT 3R-350PF <sub>5</sub> SKT 3R-350P <sub>7</sub>	350±20%	I	≤800	100	10	135	≥10 <sup>10</sup>	<1	≤200
		II	≤600	/					
SKT 3R-470PF <sub>5</sub> SKT 3R-470PF <sub>7</sub>	470±20%	I	≤900	100	10	135	≥10 <sup>10</sup>	<1	≤200
		II	≤700	/					
SKT 3R-600PF <sub>5</sub>	600±20%	≤1200	100	10	10	135	≥10 <sup>10</sup>	<1	≤200

Note: Specification are subject to change without notice.

**Kingtronics® International Company**

Website: [www.kingtronics.com](http://www.kingtronics.com)

Email: [info@kingtronics.com](mailto:info@kingtronics.com)

Tel: (852) 8106 7033

Fax: (852) 8106 7099